

SOTAR® PARTS LIST

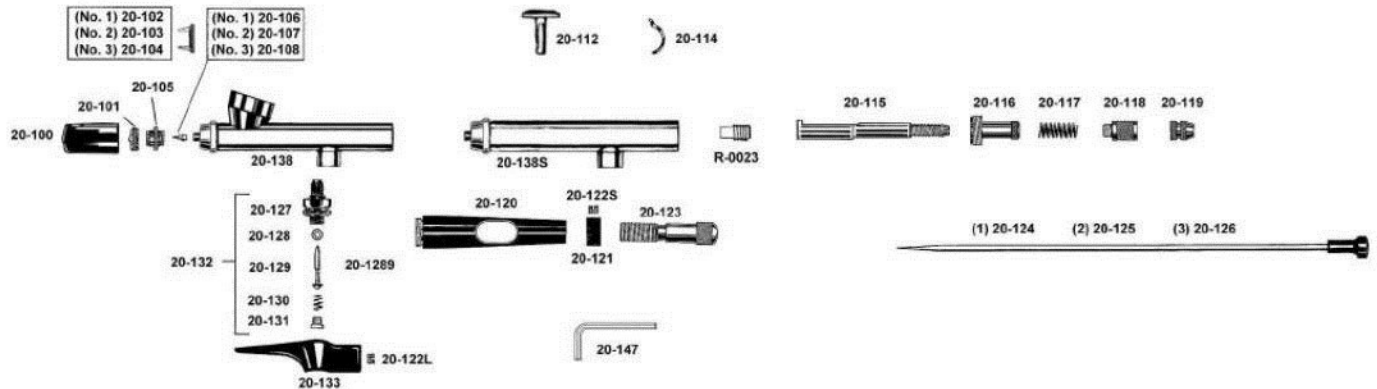

No. DESCRIPTION

20-100 Protective Cap (Rubber)
 20-101 Spray Regulator, Fine (No. 1)
 20-102 Spray Regulator, Fine (No. 1), w/Protective Arms
 20-103 Spray Regulator, Med (No. 2), w/Protective Arms
 20-104 Spray Regulator, Large (No. 3), w/Protective Arms
 20-105 Paint Tip Hold-Down Ring
 20-106 Paint Tip, Fine (No. 1)
 20-107 Paint Tip, Medium (No. 2)
 20-108 Paint Tip, Large (No. 3)
 R-0023 Adjustable inner seal
 20-112 Trigger
 20-114 Back Lever
 20-115 Needle Collet
 20-116 Tube Housing

No. DESCRIPTION

20-117 Trigger Tension Spring
 20-118 Retaining Spring Screw
 20-119 Chuck
 20-120 Handle
 20-121 Collar
 20-122L Finger Rest Set Screw Long
 20-122S Collar Set Screw Short
 20-123 Paint Adjusting Screw
 20-124 (No. 1) Needle, (Fine-Black)
 20-125 (No. 2) Needle, (Medium -White)
 20-126 (No. 3) Needle, (Large-Clear)
 20-127 Air Valve Casing
 20-128 Valve Plunger O-Ring
 20-1289 Valve Plunger (Only)

No. DESCRIPTION

20-129 Valve Plunger w/O-Ring
 20-130 Plunger Spring
 20-131 Air Valve Screw
 20-132 Air Valve Assembly, Complete
 20-133 Finger/Thumb Rest (Plastic)
 20-138 Body (2020-2 Color Cup)
 20-138S Body(2020-S no Color Cup)
 20-143 Fine Needle/Nozzle Conversion Kit
 (consists of 20-101, 20-106, 20-124)
 20-144 Medium Needle/Nozzle Conversion Kit
 (consists of 20-103, 20-107, 20-125)
 20-145 Large Needle/Nozzle Conversion Kit
 (consists of 20-104, 20-108, 20-126)
 20-147 Allen Wrench For Set Screw